

6. Don't forget to switch on continuous light!

To ensure that your BikeTrax GPS tracker is powered, you must turn on the continuous light. There are two ways to do this:

1.

Set continuous light via bike display

Display type 1

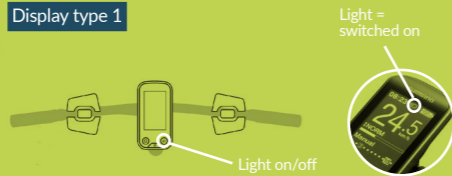

Display type 2



1. Press and hold <A> key until the settings menu opens.
2. Select menu item [Light] with <X>/<Y> and confirm with <A>.
3. Select [Light ON] with <X>/>Y> and confirm with <A>.

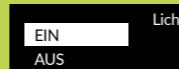

Set continuous light via „E-Tube Project“ app



1. Download Shimano app called „E-Tube Project“ from the Google Play Store or App Store



2. In the menu item „Customize“ you can change all settings for your e-bike.
3. Follow the instructions in the app to set up continuous light.

The Shimano app is free of charge!

IMPORTANT INSTRUCTIONS

! The **initial operation** of your BikeTrax GPS tracker **should be performed outdoors**. This will ensure a fast connection with good network coverage.

! **Metallic objects** and coatings can **degrade the reception of GPS, GPRS and GSM signals**. Therefore, it is important that the BikeTrax GPS tracker is not hidden inside the e-bike frame or mounted with the GPS antenna (PowUnity logo) facing inwards. This can affect performance.

GOOD RIDE

BIKE TRAX GPS anti-theft protection for e-bikes

ASSEMBLY INSTRUCTION for SHIMANO e-bike systems*

Compatible with:

- Steps E5000 • E5080
- E5080-H • E6100
- E6110 • E6180 • E6002
- E6012 • E7000
- E8000 • E8080
- EP8000

With additional light adapter also for Steps...

- E6000 • E6001
- E6010 • E6050**



15 min.



**available on request at PowUnity

e-mail: info@powunity.com
powunity.com

powunity

POWUNITY.COM

PACKAGE CONTENTS



★ Every e-bike model is different, and especially cable covers, displays, batteries & co. are available in a variety of different designs. **Therefore we ask for your understanding if the illustrations in this assembly instruction and the motor of your e-bike don't correspond.**

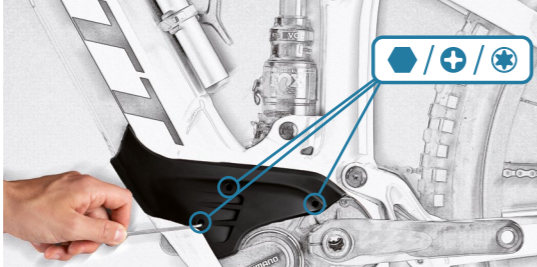

1.

1. Remove cable cover and battery

The cable cover and battery of your e-bike can easily be removed with the right tools.

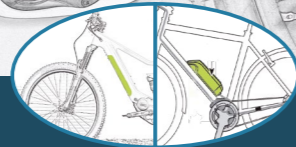

2.

2. Open mounting bolts

Loosen the two mounting bolts of the light connection with a screwdriver! Depending on your e-bike model, the mounting bolts may be in a different location.*

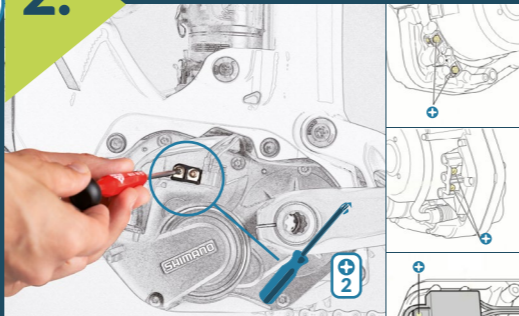

* For more information on the location of your light connection, please refer to your e-bike manual.



3.

3. Attach connection cable and secure with mounting bolts

ATTENTION: Depending on availability you will receive a red/black or a black and white/black cable. Please pay attention to correct polarity when positioning the cable (see above).

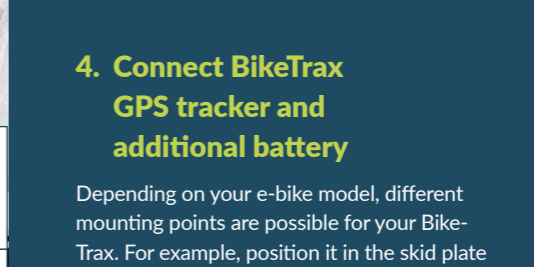

4.

4. Connect BikeTrax GPS tracker and additional battery

Depending on your e-bike model, different mounting points are possible for your BikeTrax. For example, position it in the skid plate with double-sided adhesive tape.



5.

5. Reattach cable cover

Make sure that the mounted parts are under no stress. The cover should fit snugly onto the threaded holes of the frame and be screwed tightly.

