

Installation Instructions

SpeedBox Tracker
for Yamaha

STEP 1

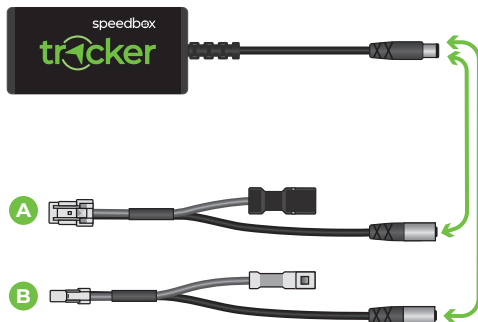

A



DISPLAY CABLE

B



LIGHT CABLE



lights must be
permanently **ON**

A STEP 2

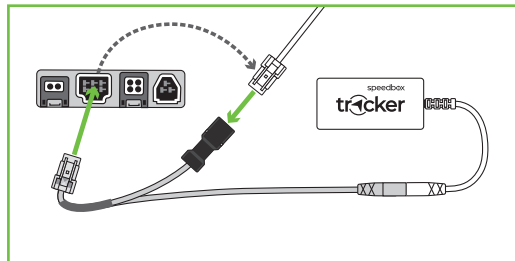

B STEP 2

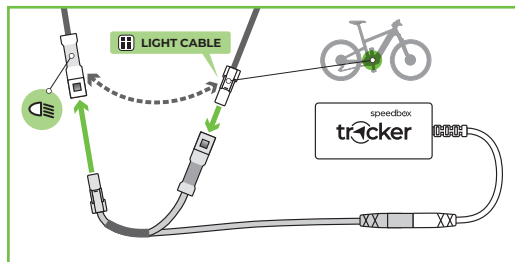

How to connect SpeedBox Tracker along with SpeedBox Tuning

Existing SpeedBox Tuning installation

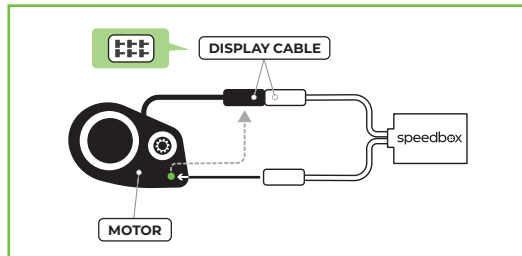

A1 Installation of SpeedBox Tuning along with SpeedBox Tracker

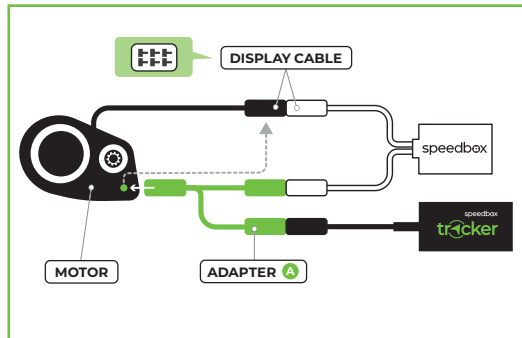

A2 Installation of SpeedBox Tuning along with SpeedBox Tracker

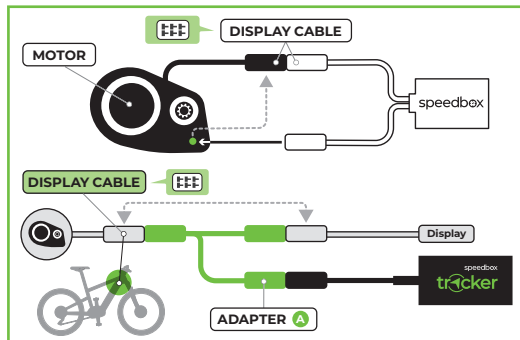

B Installation of SpeedBox Tuning along with SpeedBox Tracker

