

## SpeedBox 3.2 for Ginat

### STEP 1: Preparation for installation

- A.** Prepare the following tools:
1. Precision slotted screwdriver
  2. Hex Key H3
  3. Hex Key H5
  4. Hex Key H8
  5. T30 Torx screwdriver
  6. T25 Torx screwdriver
- B.** Turn off the e-bike.
- C.** Remove the battery from the e-bike according to the manufacturer's manual.

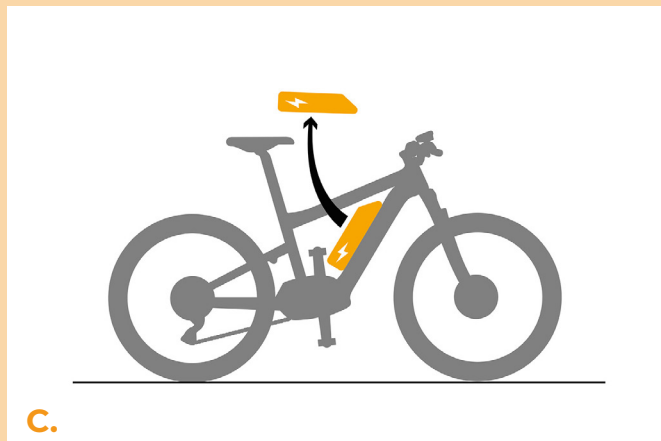
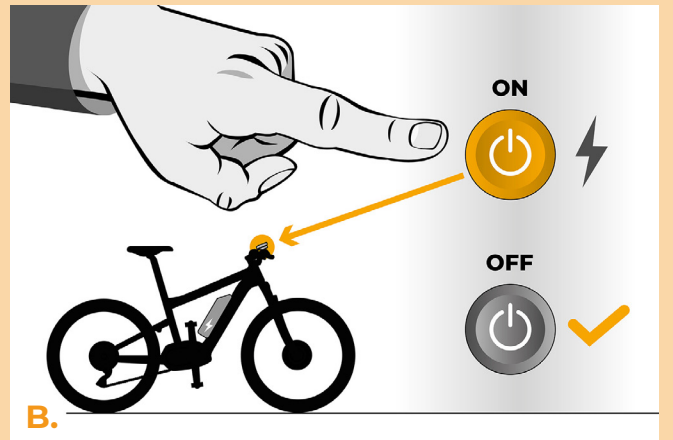
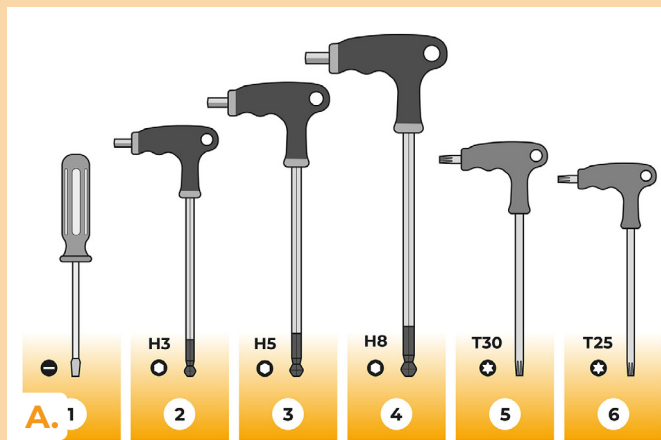

## STEP 2: Removing the crank and chainring

- A.** On the left side of the bike, loosen the screws holding the motor in the bike frame using the T30 Torx screwdriver. Remove the top screw completely, but leave the bottom screw in place, just loosen it.
- B.** Turn the e-bike upside down.
- C.** On the chain side, remove the locking bolt of the left crank using the H8 hex key and take off the crank. If the locking bolt is not self-extracting, you will need to use a crank puller. Refer to the „User Manual“ on the website for detailed instructions.
- D.** Flip up the chain guide.

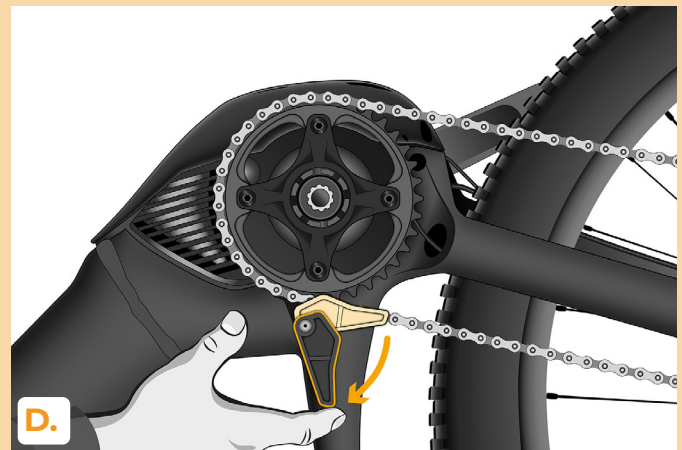
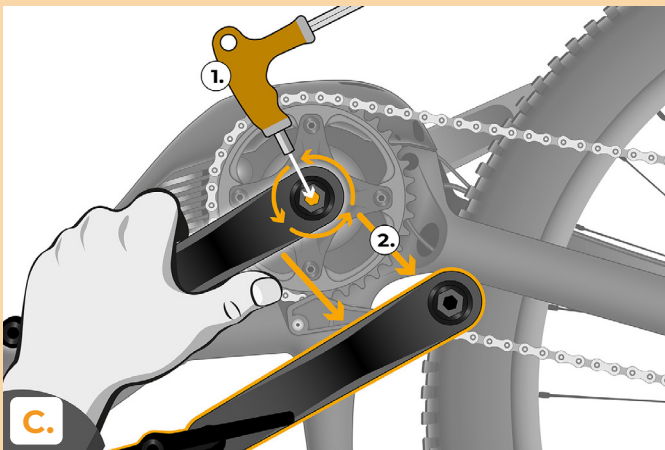
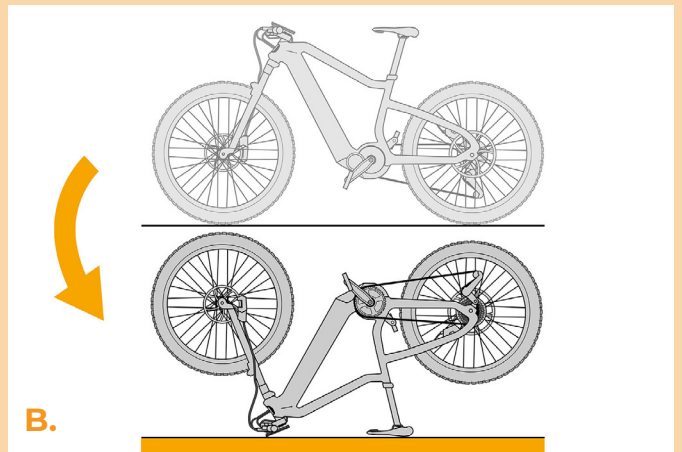

- E.** Remove the chain.
- F.** Unscrew the bolts holding the chainring using the H5 hex key.
- G.** Remove the chainring.

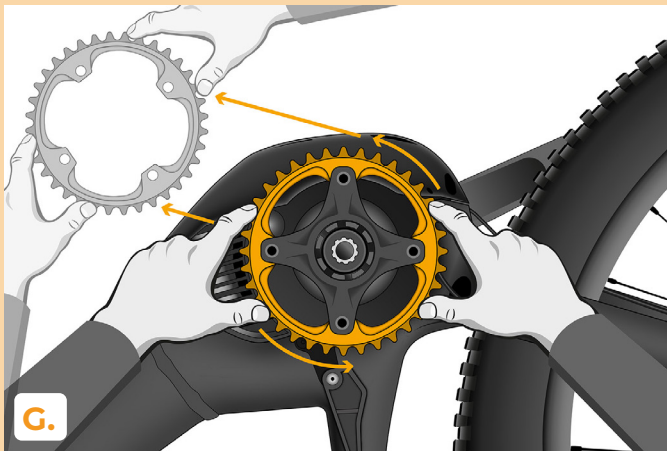
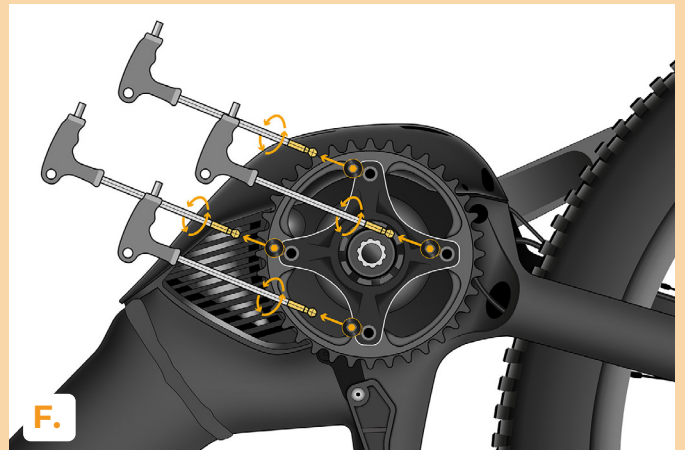
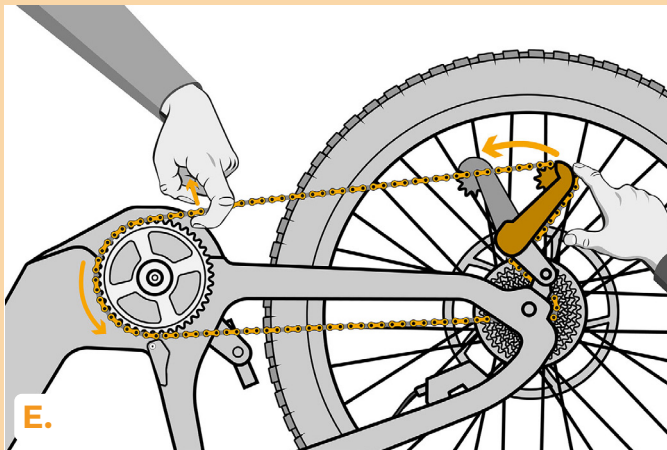

## STEP 3: Motor removal

- A.** Unscrew the bolts holding the motor cover (Torx T25).
- B.** Remove the motor cover.
- C.** Loosen the bolts holding the motor in the frame (Torx T30). Remove the bottom bolt completely, but leave the one near the rear wheel only loosened.
- D.** Gently pull the cables and housing out of the bike frame so that the e-bike motor can be tilted out.
- E.** Tilt the motor and support it (with a screwdriver or another solid object) to access the connectors.

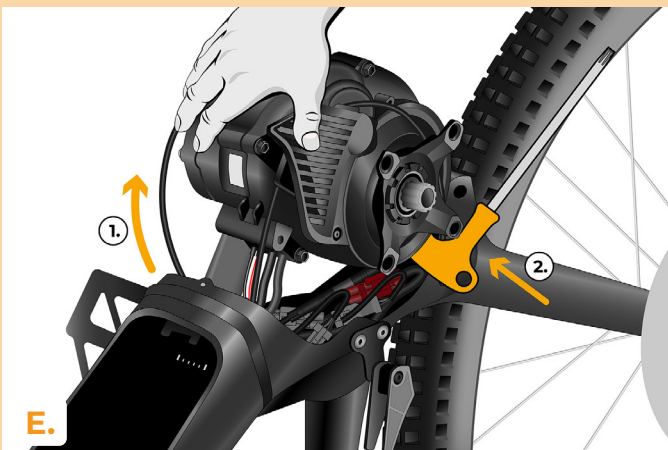
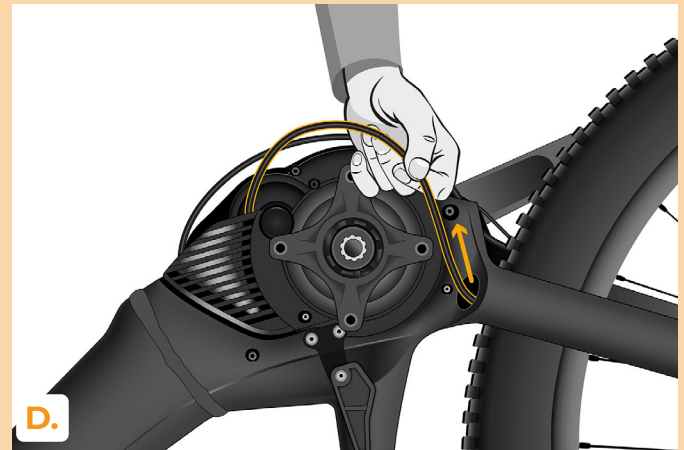
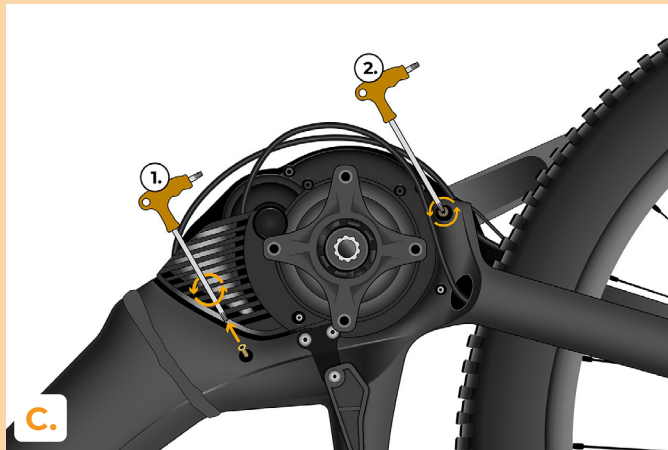
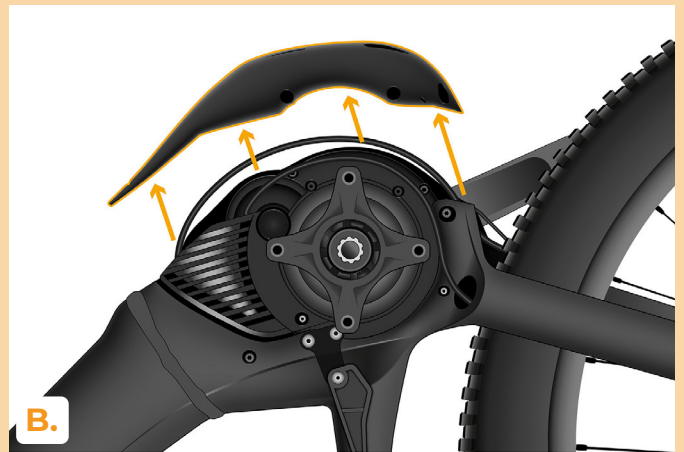
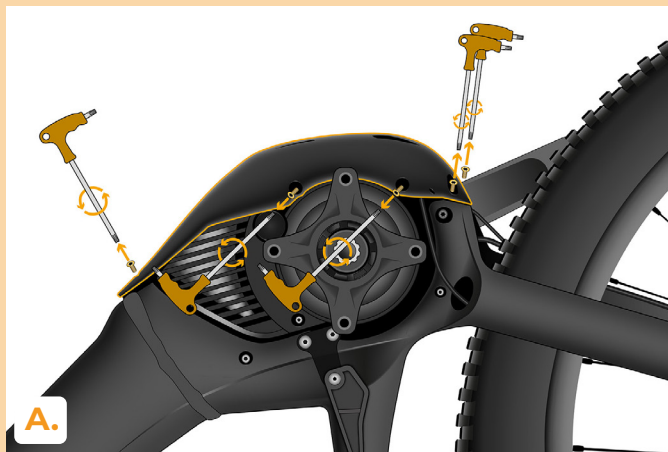

## STEP 4: Disconnecting the connectors from the motor

- A.** Disconnect the speed sensor cable connector using the precision slotted screwdriver.
- B.** In the same way, disconnect the connector of the cable leading from the motor to the display. It may be covered by heat shrink tubing, which needs to be carefully removed.

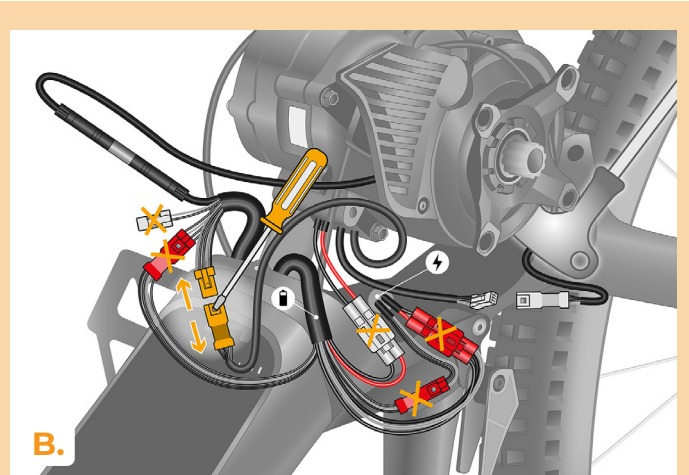
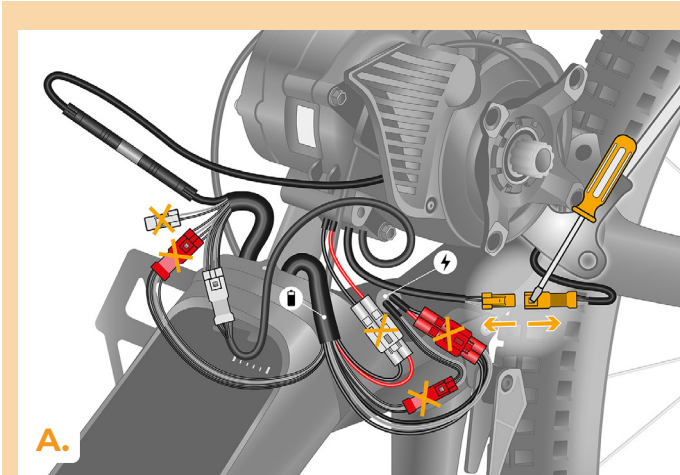



## STEP 5: SpeedBox tuning installation

- A.** Plug SpeedBox into the disconnected connectors (step 4).
- B.** Make sure that the locks on the connectors are seated properly.
- C.** Before reassembling the motor, check the correct wiring according to the figure.

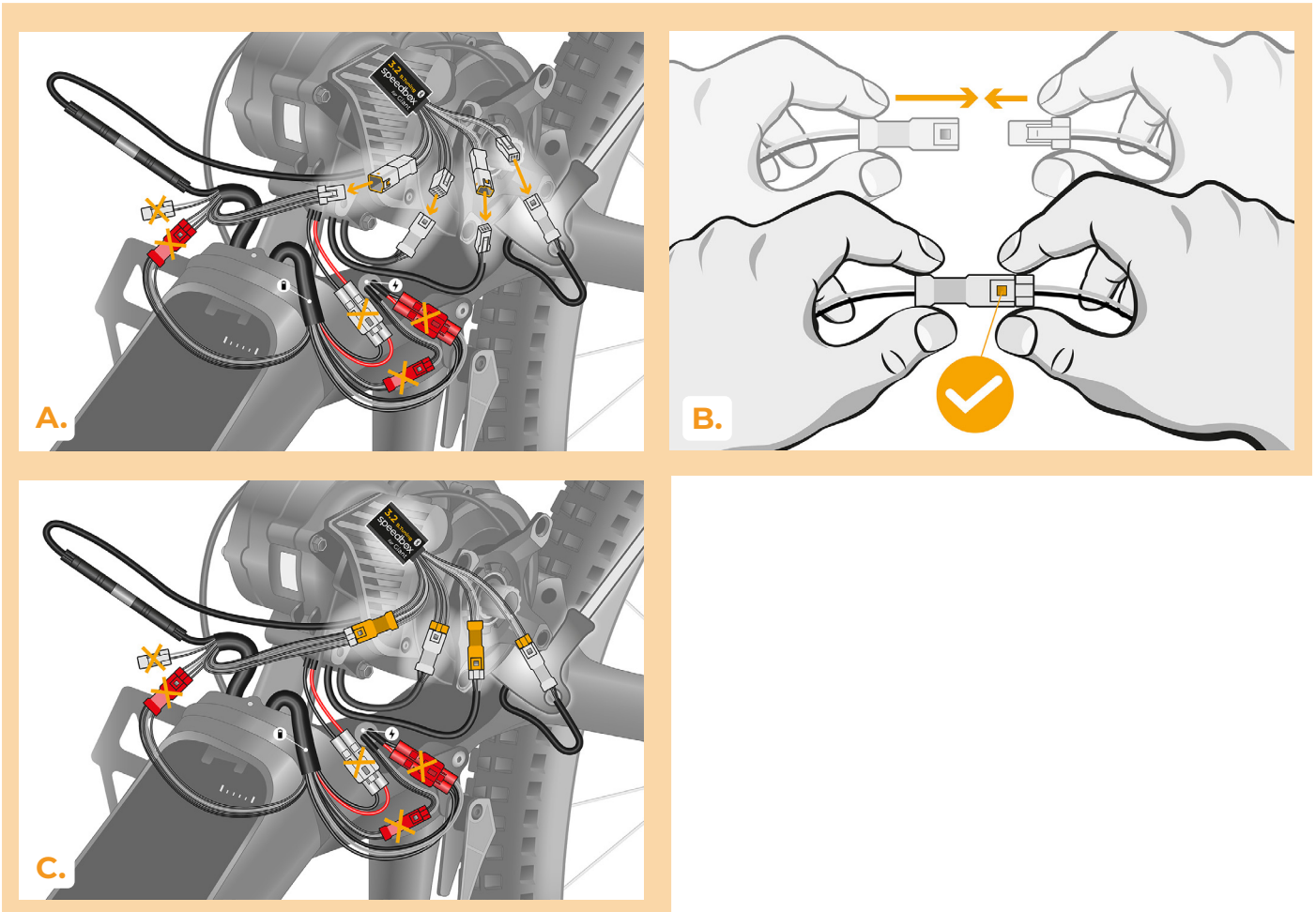

## STEP 6: Motor cover assembly

- A.** Place the connectors and wiring from the motor back into the free space within the e-bike frame. Keep the SpeedBox slightly pulled out of the frame so that the metal frame does not interfere with the Bluetooth signal.
- B.** Screw the bolts holding the motor in the bike frame back in place and tighten them securely.
- C.** Return the cables and housings back into the bike frame so that they fit under the motor cover.
- D.** Place the SpeedBox on the motor so that it does not obstruct the reinstallation of the cover. Then, attach the plastic motor cover back to its original position.

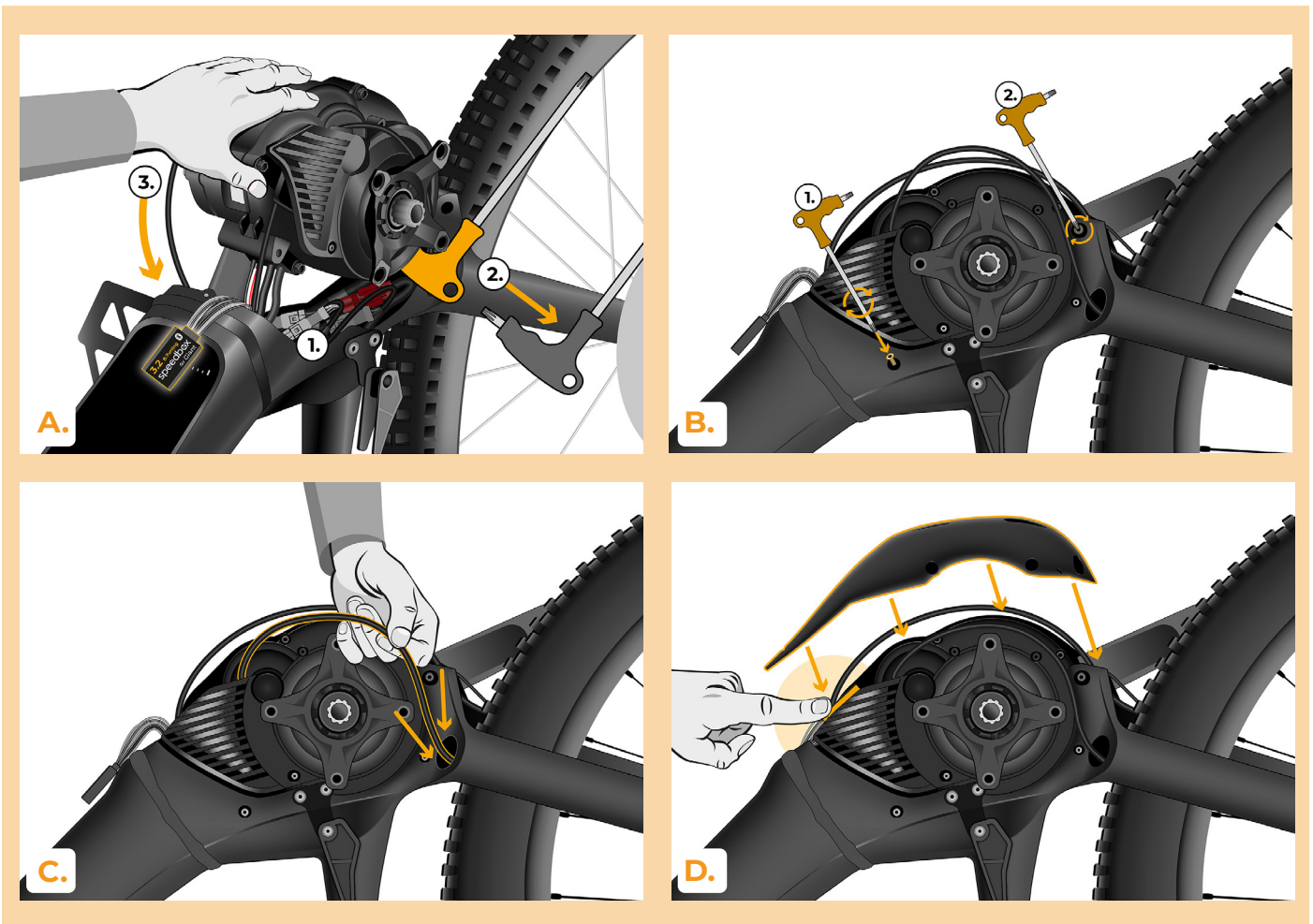

- A.** Screw the cover back in place using the T25 Torx screwdriver.

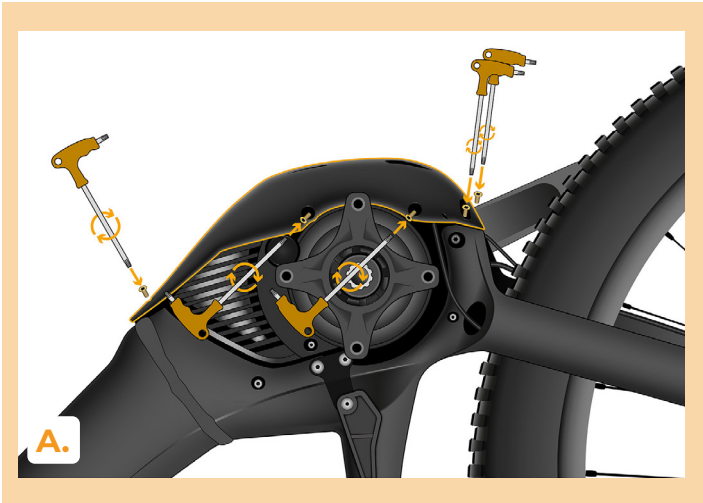

## STEP 7: Crank assembly

- A.** Place the chainring back and screw it in using the H5 hex key.
- B.** Reinstall the chain onto the chainring.
- C.** Flip the chain guide back into place.
- D.** Check the tightening of the bolts holding the chainring.
- E.** Reinstall the crank and screw in the locking bolt using the H8 hex key.
- F.** Turn the e-bike back onto the tires.
- G.** Screw the bolt holding the motor back into the bike frame, and tighten the second one on the left side.

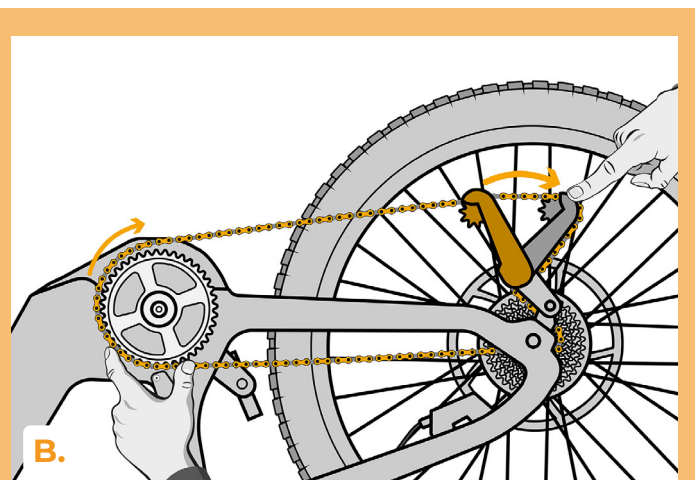
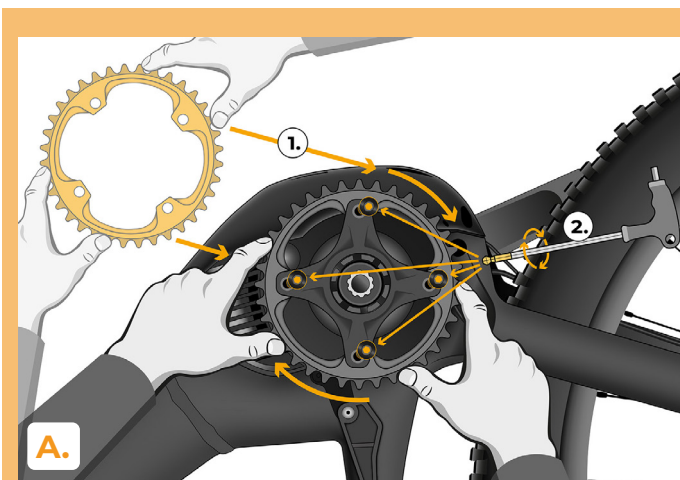



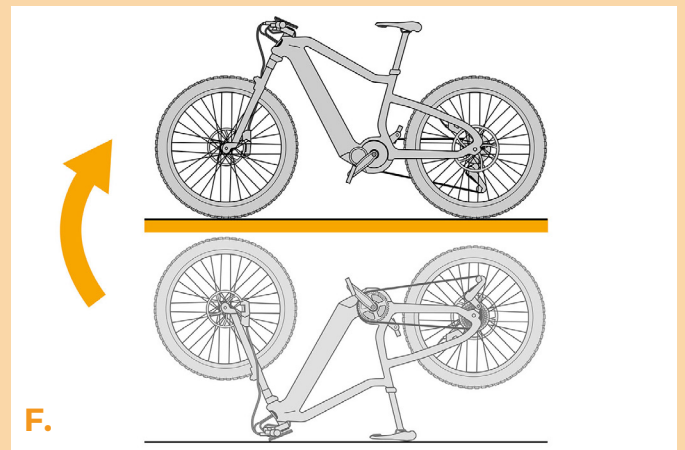
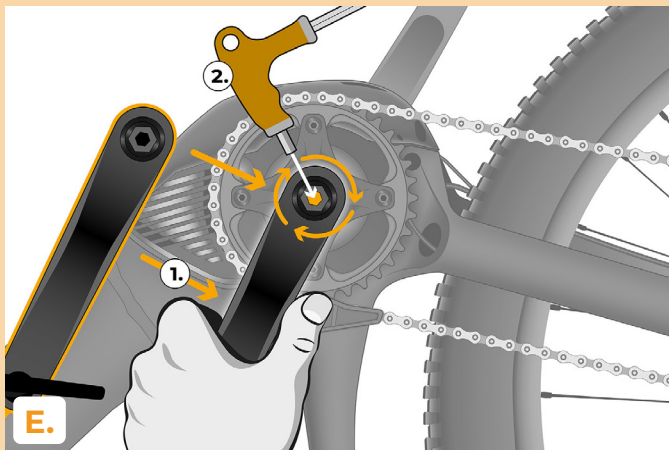
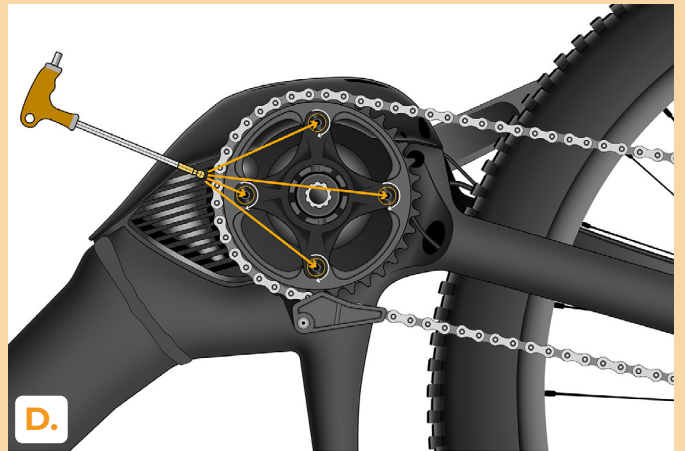
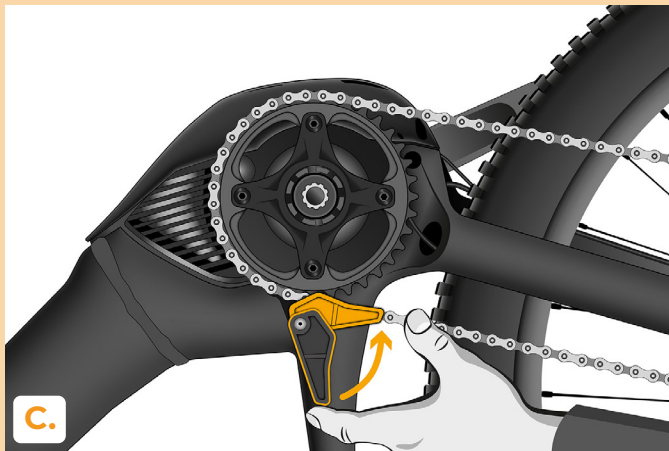

## STEP 8: Tuning function check

- A.** Place the battery back into the e-bike.
- B.** Turn the e-bike on.
- C.** You will activate/deactivate tuning by brief activation of the WALK function or by switching between two assistance modes twice (+ - + -). The value of 5.0 or 2.5 indicating the maximum speed of 50 or 25 km/h will be displayed.
- D.** Spin the rear wheel and make sure the rear wheel speed is shown on the e-bike display.

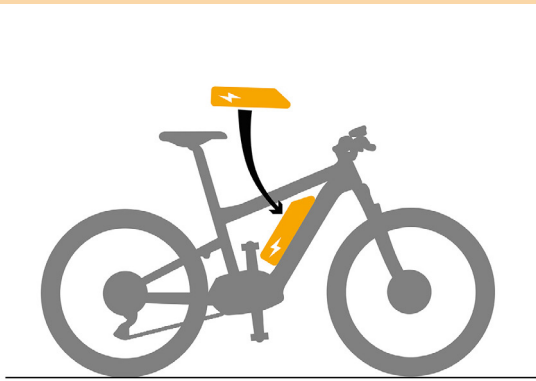

**A.**

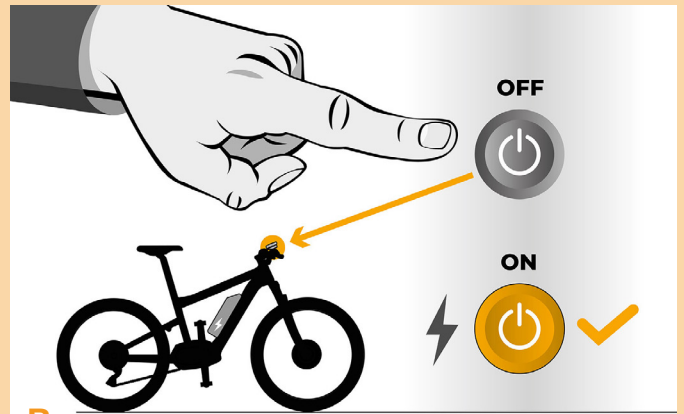

**B.**

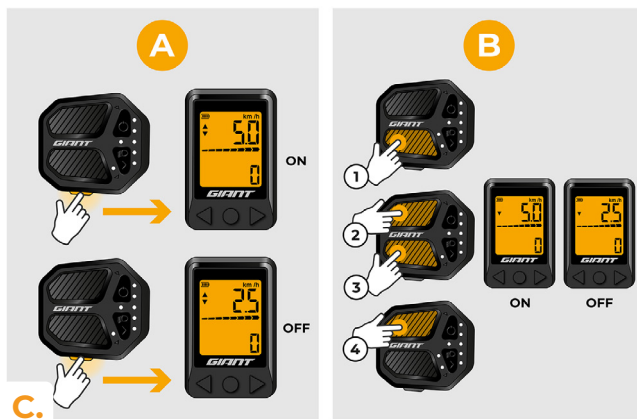

**C.**



**D.**

## STEP 9: Setting the speed limit

- A.** To set the maximum speed limit, switch the modes: - - - + +. The current speed limit will be displayed.
- B.** Set the maximum speed limit by pressing the WALK button briefly or by turning the rear wheel 360°. With each brief activation of the WALK function or turning of the wheel, the limit increases by 5 km/h. The last displayed limit is saved after five seconds of inactivity.

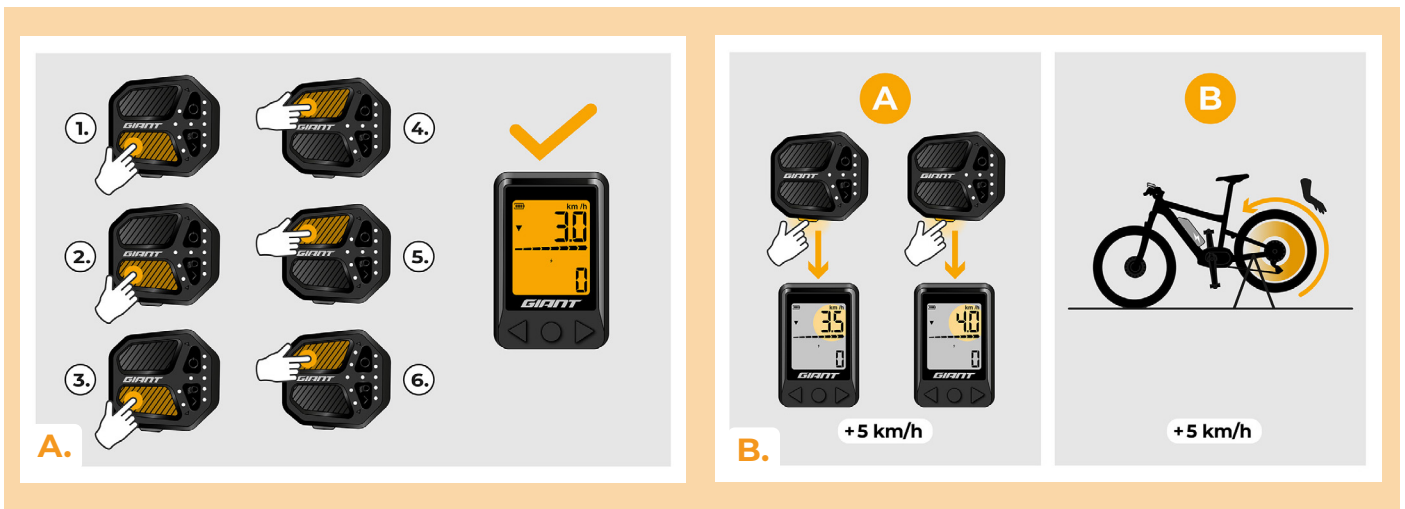

[www.speedbox-tuning.com](http://www.speedbox-tuning.com)

Ebike Electronic s.r.o.

Rybna 716/24 | 110 00 Praha 1 | Czech Republic | ID: 05553555 | VAT: CZ05553555

