

## SpeedBox 2.0 for Yamaha UR

### STEP 1: Preparation for installaion

- A.** Prepare the following tools:
1. Hex Key H3
  2. Hex Key H6
  3. precision slotted screwdriver
- B.** Turn off the e-bike.
- C.** Remove the battery from the e-bike according to the manufacturer's manual.

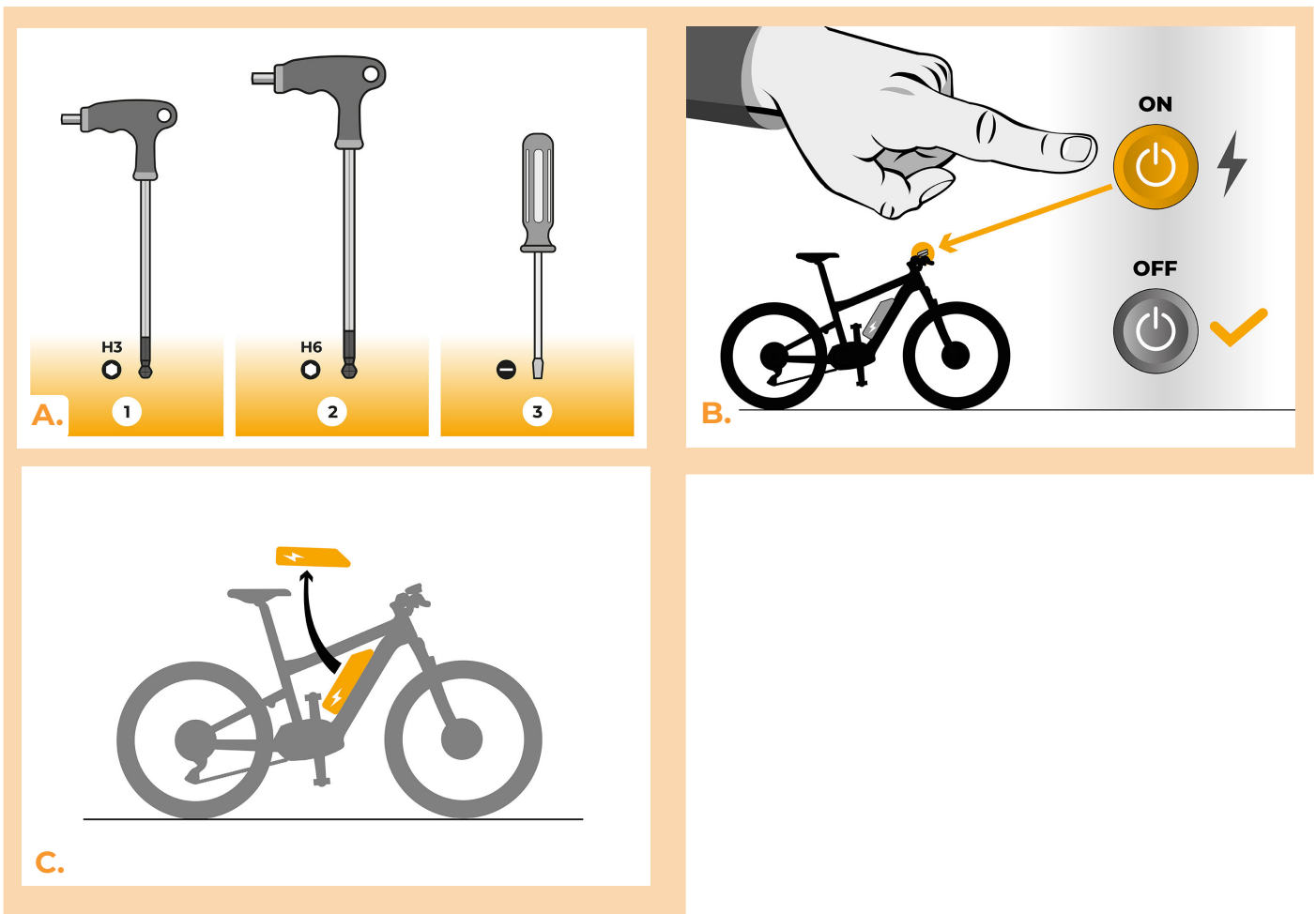

## STEP 2: Crank removal

- A. Unscrew the four screws holding the motor cover with the Hex Key H3.
- B. Remove the motor cover.

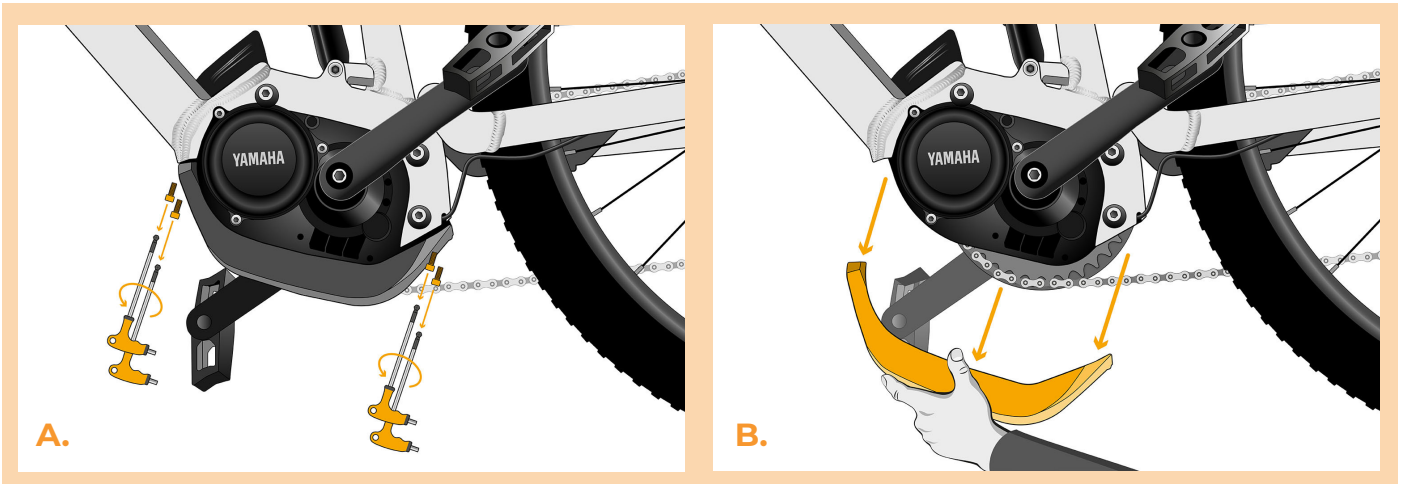

## STEP 3: Lowering the Motor

- A. Slightly loosen the bottom screw holding the motor. Unscrew the upper two screws with the hex key H6 and pull them out.
- B. Carefully tilt the motor out of the e-bike frame to access the motor connectors and wiring.

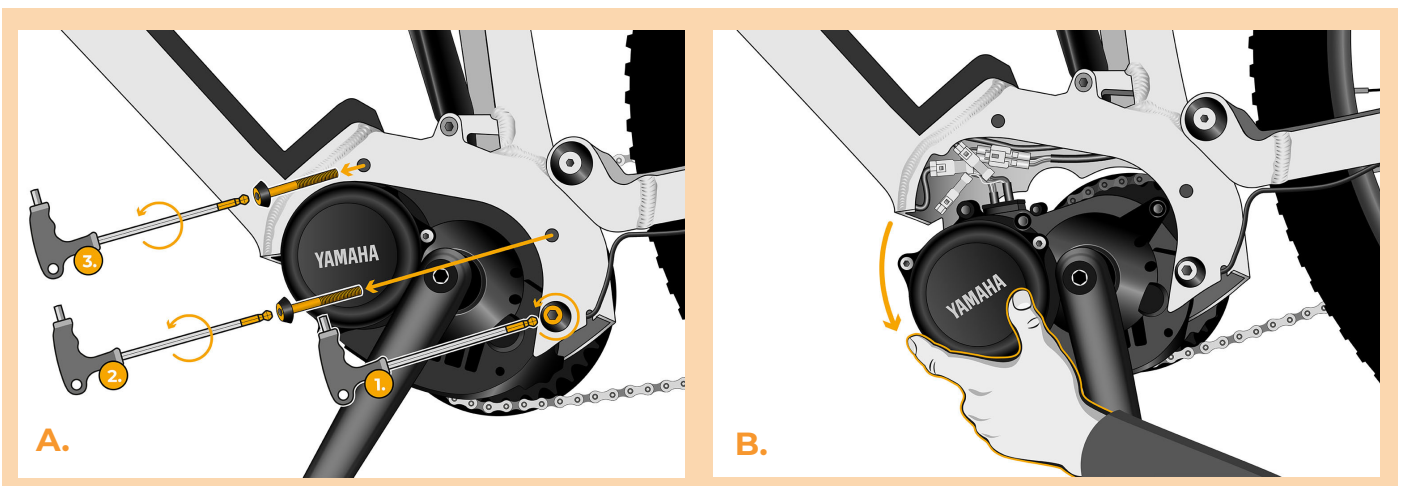

## STEP 4: Disconnecting the connectors from the motor

- A. Disconnect the speed sensor connector with the slotted screwdriver.
- B. Disconnect the display connector in the same manner.

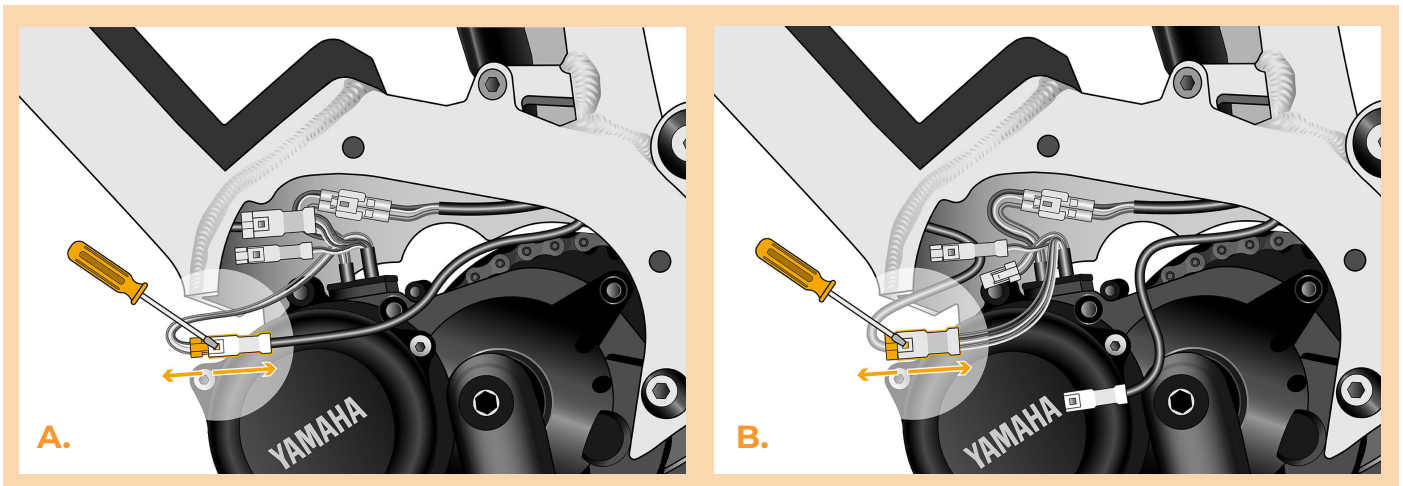

## STEP 5: SpeedBox tuning installation

- A.** Plug SpeedBox into the disconnected connectors (step 4).
- B.** Make sure that the locks on the connectors are seated properly.
- C.** Before assembling the motor, check the correct wiring as shown in the figure.

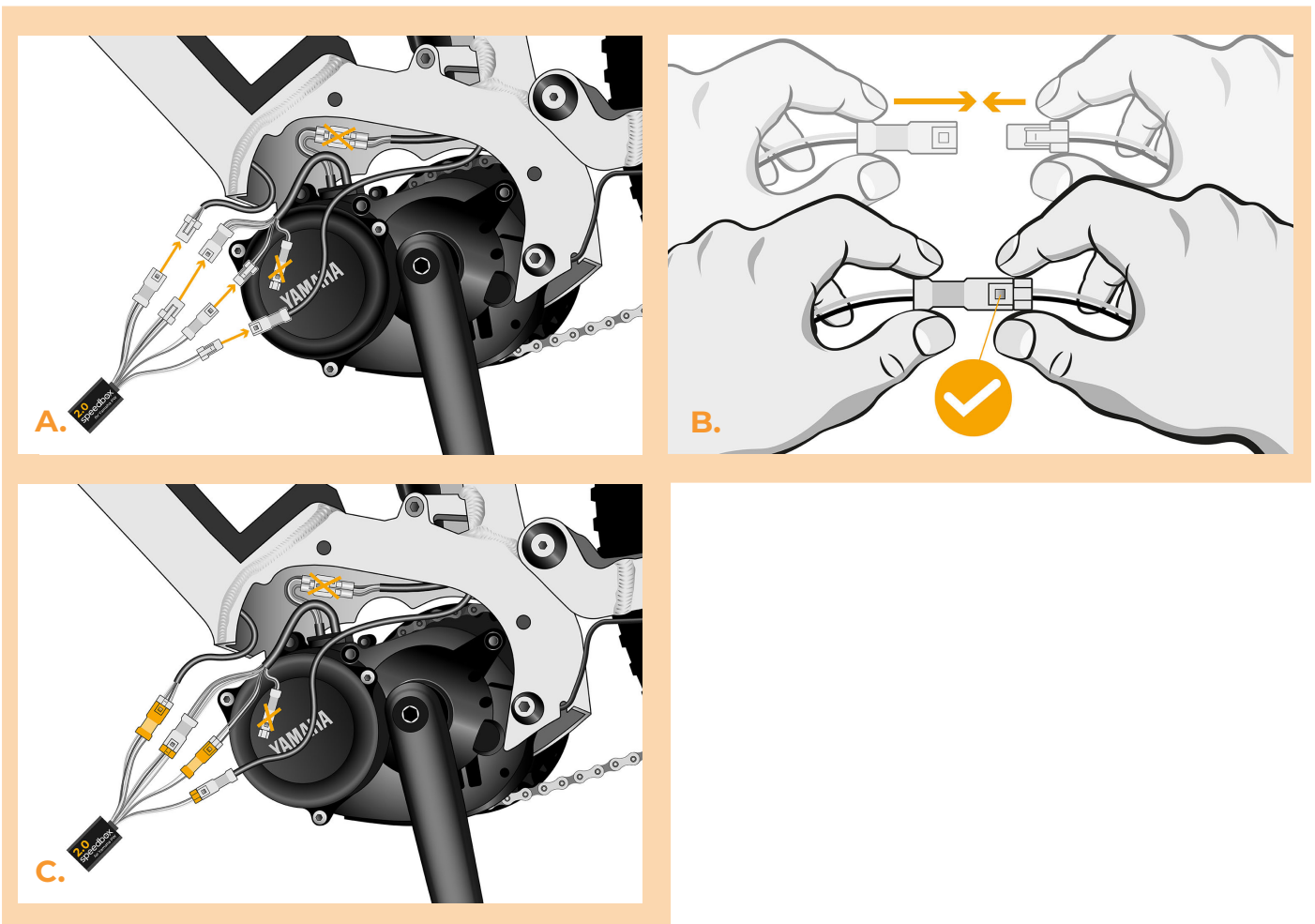

## STEP 6: Motor cover assembly

- A.** Place the connectors and wiring leading from the motor back into the free space in the e-bike frame.
- B.** Return the motor to its original position and be careful not to accidentally damage the cables.
- C.** Screw in the screws holding the motor in the frame and tighten well.
- D.** Place and screw the plastic engine cover back in place.

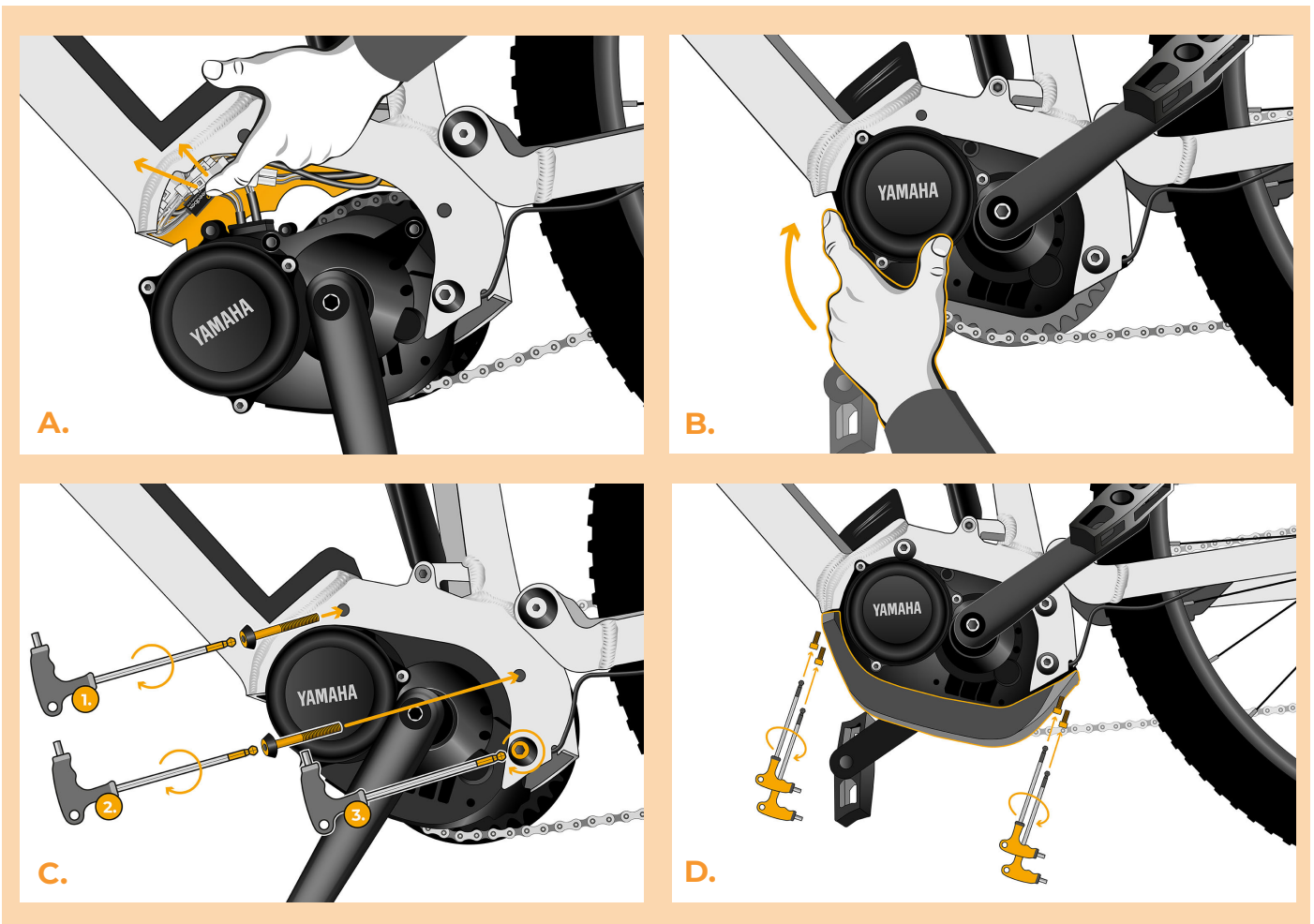

## STEP 7: Tuning function check

- A.** Place the battery back into the e-bike.
- B.** Turn the e-bike on.
- C.** You will activate/deactivate tuning by pressing the LIGHT button shortly or by pressing the ↑ ↓ ↑ ↓ button combination quickly ( the value of 5.0 or 2.5 will be shown indicating the maximum speed limit in km/h). Some types of displays may round to whole numbers.
- D.** Spin the rear wheel and make sure the rear wheel speed is shown on the e-bike display.

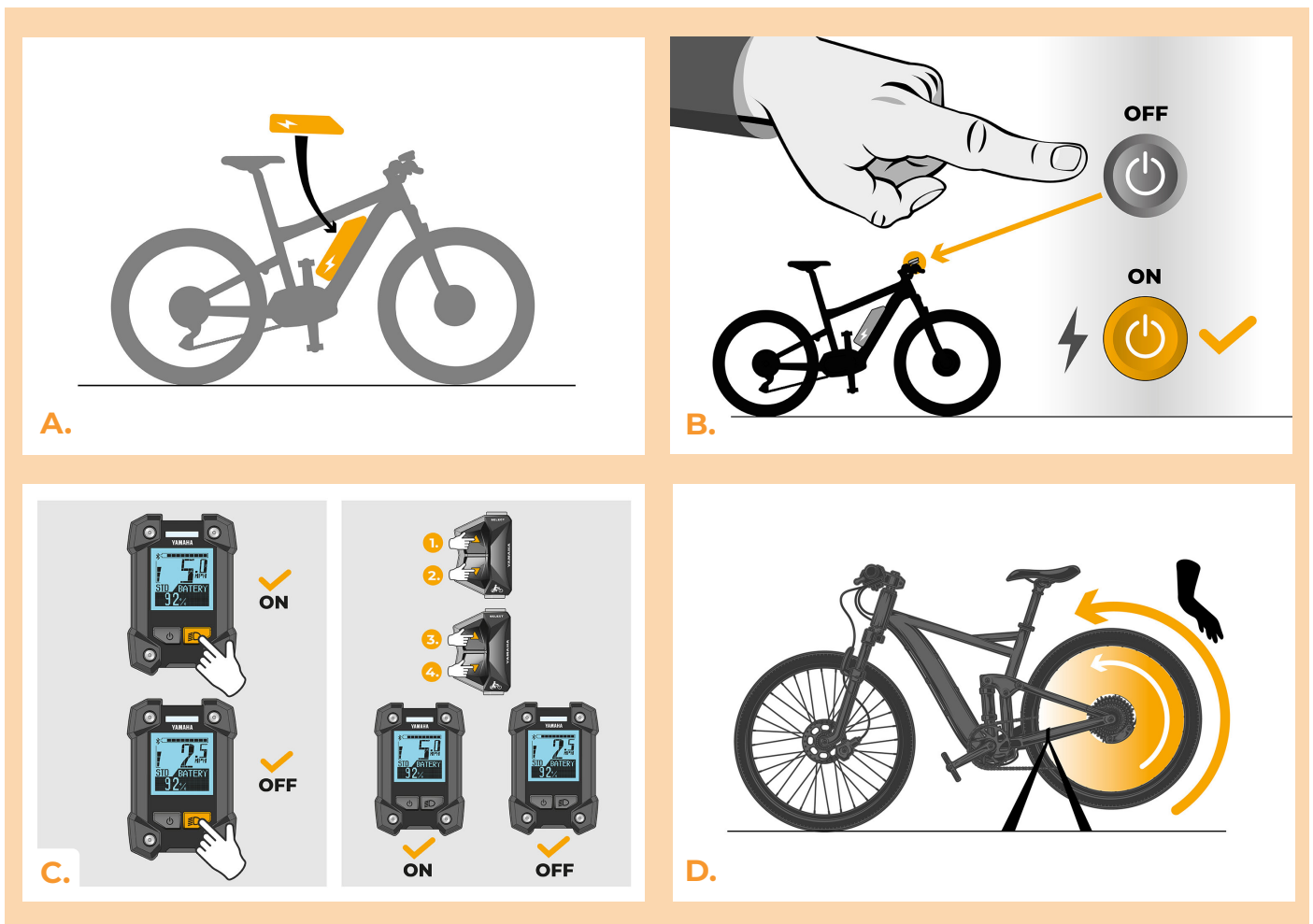



[www.speedbox-tuning.en](http://www.speedbox-tuning.en)

Ebike Electronic s.r.o.

Rybna 716/24 | 110 00 Praha 1 | Czech Republic | ID: 05553555 | VAT: CZ05553555

